

SPECIFICATION

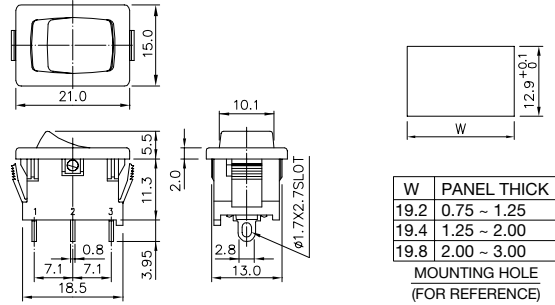

RATING:	15.1A 125VAC, 8A 250VAC (UL, CUL) 10(4)A 250V~T85 (ENEC)
INSULATION RESISTANCE:	DC 500V 100MΩ OR MORE
CONTACT RESISTANCE:	DC 2-4V 1A 20mΩ OR LESS
WITHSTAND VOLTAGE:	AC 1500V FOR 1 Min
AMBIENT TEMPERATURE:	0~85°C
ELECTRICAL LIFE:	10,000 CYCLES

SIZE

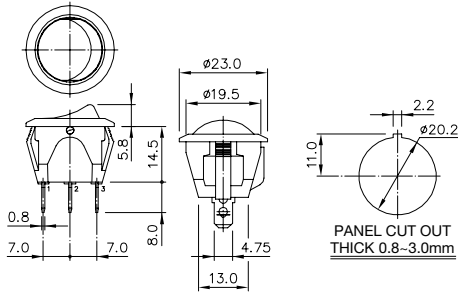

HOW TO ORDER

3010 - □ - □ - □ - □ - □ - □ - □

PRINT		TERMINAL	RATING	CIRCUIT	BODY	KNOB COLOR	BODY COLOR
P1:	P9:	T1: 3.2x0.8	G1: 10.1A 125VAC 6A 250VAC	C01: ON-OFF C02: ON-ON C03: ON-(OFF) C04: (ON)-OFF	B02:	BK: BLACK BU: BLUE RD: RED WT: WHITE	BK: BLACK BU: BLUE RD: RED WT: WHITE
P2:	P12:	T2: 4.75x0.8	G2: 15.1A125VAC 8A250VAC 1HP250VAC 1/2HP125VAC 10(4) 250V~T85		B05:		
P3:	P13:	T6: t0.8					
P4:	P14:	T8: 4.75x0.8					
P5:	P15:						
P6:	P16:						
P7:	P17:						
P8:	P20:						